



# 2024 PRICE LIST

29985 ALTA AVENUE • NORTHFIELD, MN 55057 • 612-913-1453

## LARSON PIT

### WASHED PRODUCTS:

1 1/2" Round Rock.....	\$23.50
1 1/2" Sewer Rock.....	\$23.50
1 1/2" Roofing Rock.....	\$23.50
3/4" Washed Rock .....	\$21.00
Radon Rock Washed .....	\$21.00
Coarse Filtered Aggregate .....	\$21.00
CA-67 Washed Rock .....	\$21.00
3/8" Washed Buckshot/Pea Rock.....	\$19.50
Washed Sand.....	\$ 9.00
Fine Filtered Aggregate .....	\$ 15.25

### RECYCLED PRODUCTS:

Class 5 Recycle.....	\$ 11.00
Class 6 Recycle (if available).....	\$ 11.00
Recycled 1 1/2" (if available).....	\$ 15.25
Recycled 1" Asphalt.....	\$ 15.25

### UN-WASHED PRODUCTS:

Class 5 Aggregate Base .....	\$ 8.25
Class 1 Aggregate Base .....	\$ 9.25
Class 6 Aggregate Base .....	\$ 11.00
Select Granular (0-12%) .....	\$ 5.00
Select Granular (0-6%).....	\$ 5.25
2-6" Unwashed River Rock .....	\$23.50
1 1/2"-6" Unwashed River Rock.....	\$23.50
1 1/2" Unwashed River Rock.....	\$ 17.50
3/4" Unwashed River Rock.....	\$ 15.50
Fill Sand.....	\$ 5.25
Granular Backfill .....	\$ 5.25
Common Borrow.....	\$ 4.25
Unpulverized Black Dirt .....	\$ 6.50
Pulverized Black Dirt .....	\$ 18.50

### DISPOSAL FEES:

Dumping Fee for Clean Fill .....	\$ 1.50
Dumping Fee for Clean Concrete/BIT (no metal).....	\$ 3.00
Dumping Fee for Concrete w/Metal (no garbage/wood) ..	\$ 5.00
Pump Truck/Hydro-Vac (per load).....	\$ 125

**PLEASE CALL FOR DELIVERY RATES**

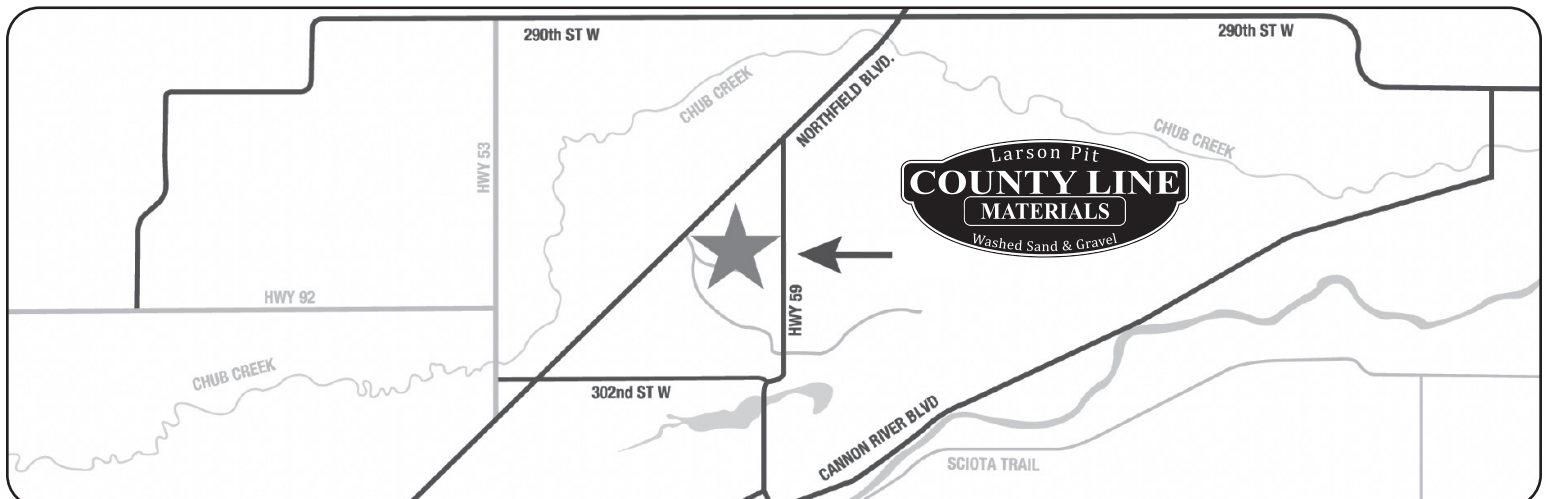

Prices effective March 1, 2024. Prices per ton. Excludes aggregated and sales tax. Terms: Net 30 days. Call for discount pricing on large quantities.