



## 2025 PRICE LIST

**29985 ALTA AVENUE • NORTHFIELD, MN 55057 • 612-913-1453**

### LARSON PIT

**WASHED PRODUCTS:**

1 1/2" Round Rock.....	\$ 24.75
1 1/2" Sewer Rock.....	\$ 24.75
1 1/2" Roofing Rock.....	\$ 24.75
3/4" Washed Rock.....	\$ 21.50
Radon Rock Washed.....	\$ 21.50
Coarse Filtered Aggregate.....	\$ 21.50
CA-67 Washed Rock.....	\$ 21.50
3/8" Washed Buckshot/Pea Rock.....	\$ 20.00
Washed Sand.....	\$ 9.80

**RECYCLED PRODUCTS:**

Class 5 Recycle.....	\$ 11.55
Class 6 Recycle (if available).....	\$ 11.55
Recycled 1 1/2" (if available).....	\$ 16.00
Recycled 1" Asphalt.....	\$ 16.00

**UN-WASHED PRODUCTS:**

Class 5 Aggregate Base.....	\$ 8.75
Class 1 Aggregate Base.....	\$ 9.75
Class 6 Aggregate Base.....	\$ 11.50
Select Granular (0-12%).....	\$ 5.25
Select Granular (0-6%).....	\$ 5.50
2-6" Unwashed River Rock.....	\$ 24.75
1 1/2"-6" Unwashed River Rock.....	\$ 24.75
1 1/2" Unwashed River Rock.....	\$ 18.50
3/4" Unwashed River Rock.....	\$ 16.25
Fill Sand.....	\$ 5.50
Granular Backfill.....	\$ 5.50
Common Borrow.....	\$ 4.50
Unpulverized Black Dirt.....	\$ 6.80
Pulverized Black Dirt.....	\$ 19.50

**DISPOSAL FEES:**

Dumping Fee for Clean Fill.....	\$ 1.50
Dumping Fee for Clean Concrete/BIT (no metal).....	\$ 3.00
Dumping Fee for Concrete w/Metal (no garbage/wood).....	\$ 10.00
Pump Truck/Hydro-Vac (per load).....	\$ 125

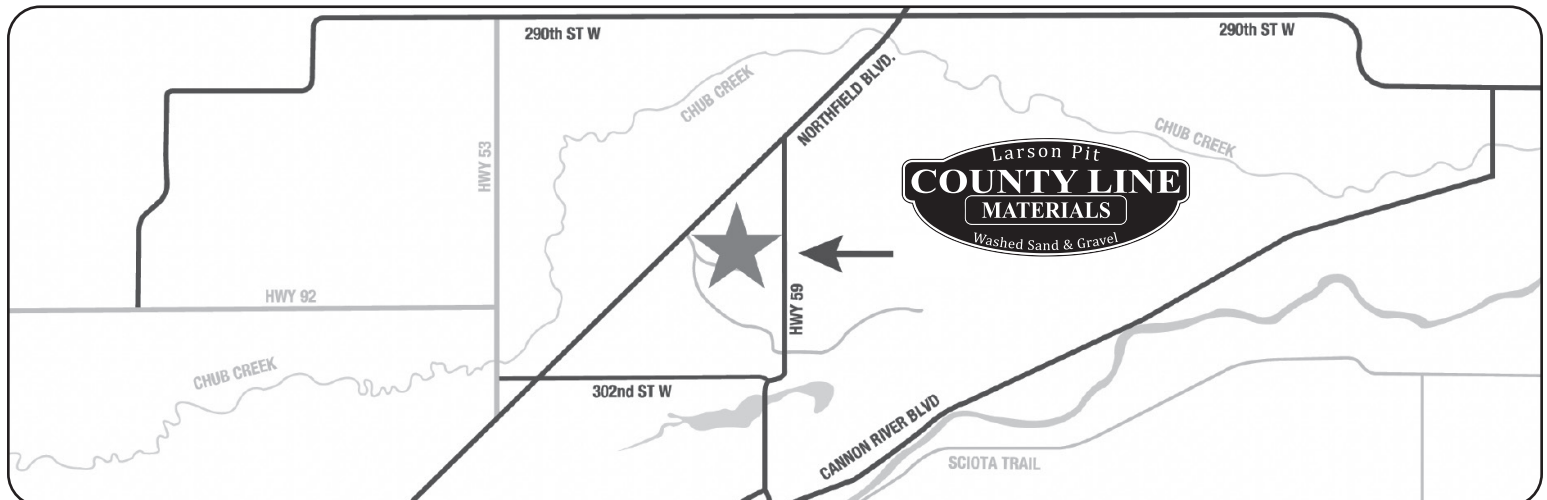

Prices effective March 1, 2025. Prices per ton. Excludes aggregated and sales tax. Terms: Net 30 days. Call for discount pricing on large quantities.